

NOTE: This home may require wall bracing tie-downs depending on wind/seismic design. Please refer to the permit set for tie-down loads and locations if applicable. Some areas of the exterior wall sheathing may be shipped loose to allow access for tie-down installation. All tie-down designs are by others.

2LM2401-V39		09/23/21 09:26 AM		By: abernhart	
QTY	U/M	SUPPLIER	DESCRIPTION	CLASS	
1	Each	MI	Window, MI TR-3009	Window	
2	Each	MI	Window, MI 2430	Window	
2	Each	MI	Window, MI 3050	Window	
1	Each	MI	Window, MI Sliding Triple 7450-XOX	Window	
1	Each	MI	Window, (2) MI 3050-2	Window	

"FOR APPRAISAL
USE ONLY"

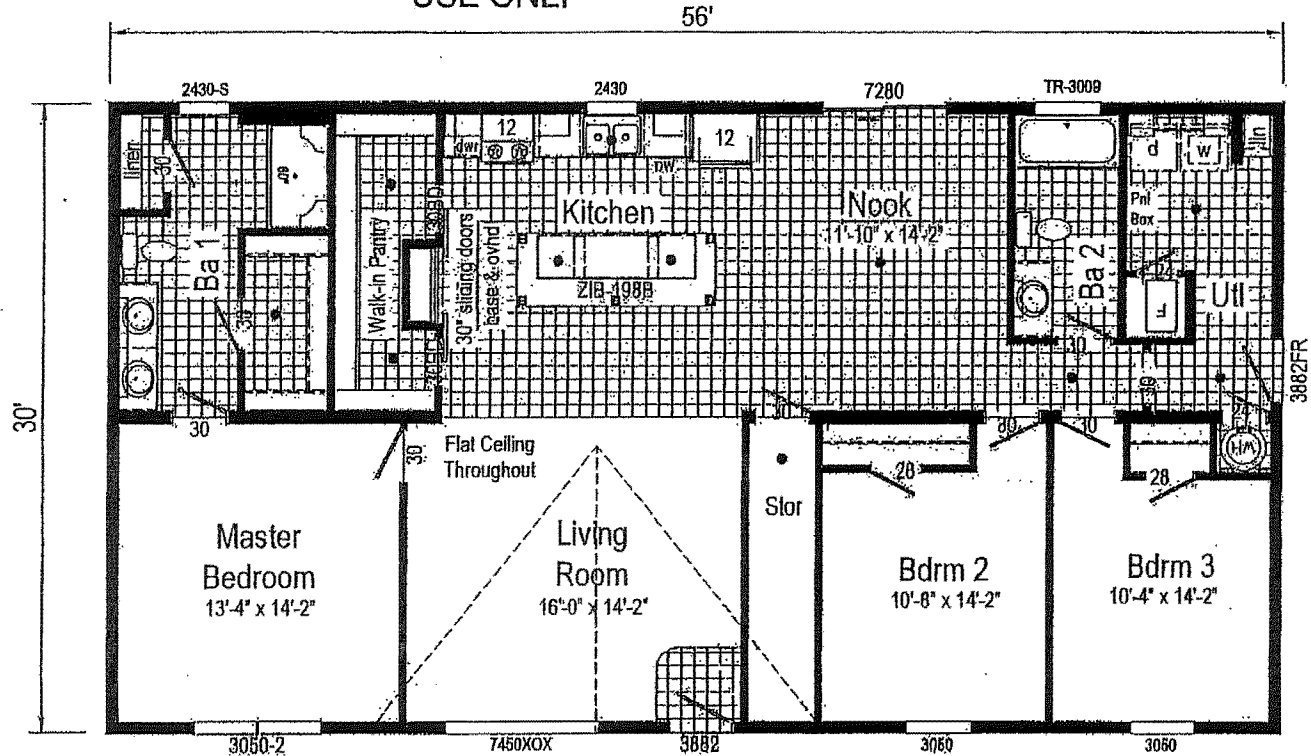

"FOR APPRAISAL
USE ONLY"

Note: Because of varying state requirements and optional equipment, some or all of the utility locations might change per floor plan (ie: furnaces, w/h, stairwell). Consult your sales representative for exact specifications.

2LM2401-V39 3256 Approx. 1680 Sq. Ft.

Builder: Commodore Homes of Indiana	Callout: 3256	Revisions:	Scale: 1/8" = 1'-0"	Date: 9/23/21	Cont: STOCK 34	Model/Eng. No.: 2LM2401-V39
Title: Literature		Drawn By: AB	Reference: 2LM2401-V2		Dir: MODERN SD	LIT
					S/N: 18358	Pg: 1

MIDDLE SCHOOL
and
High School

SMOKEY GROVES ANASTATION 710
The City of Chamberslain in
the SW 1/4 of Section 27, Township
104 North, Range 71, West of the
5th P.M.

HOSPITAL

